

TC Threaded-Body Single Acting Hydraulic Cylinder

Piston: Ø12~Ø25 mm | Pressure Max: 500 bar

Introduction

- TC Threaded-Body cylinders are compact, allowing them to be directly fixed to pre-threaded locations on fixtures. When arranged for use, they effectively reduce the required installation space.
- The hydraulic lines can be concealed within the fixture plate. However, when installing, it's necessary to place a leak-preventing gasket at the bottom to prevent hydraulic oil leakage from the threaded area.
- TC bolt cylinders are single-acting cylinders that use spring force for return to their original position. Therefore, no loads should be applied during the return stroke.
- During installation, ensure that the angle of contact between the top and the workpiece does not exceed 10 degrees. Also, pay attention to the flatness of the sealing surface of the installation hole and its perpendicularity to the hole's axis.
- When installing, first insert the white sealing ring. When tightening, avoid excessive force; simply tighten until it doesn't leak oil. Excessive force during tightening can reduce the sealing effectiveness of the sealing ring or even cause it to lose its leak-proof function due to excessive deformation.
- This cylinder comes in two types: A and B. Type A features a rounded contact surface, while Type B has threads for securing custom connectors.



Part-No.

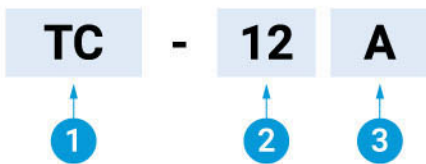

No.	Meaning	Option
1	Series	TC
2	Rod Diameter	Ø12 / Ø16 / Ø20 / Ø25
3	Rod Type	A / B

Specifications

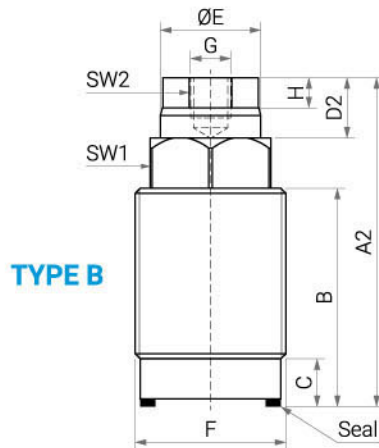
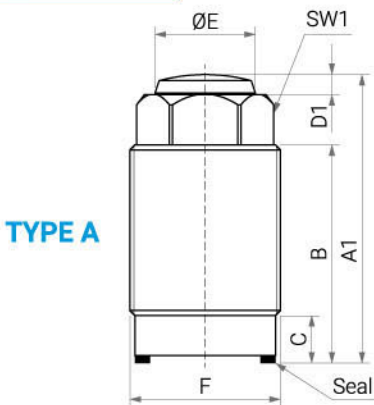

Installation Hole Diagram

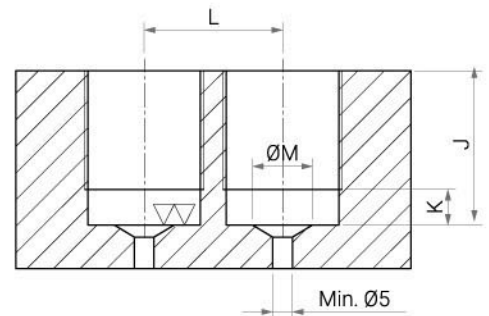

Items	Unit	TC-12	TC-16	TC-20	TC-25
Rod Diameter	mm	Ø12	Ø16	Ø20	Ø25
Stroke	mm	10	12	15	16
Force (100 bar)	kN	1.1	2	3	4.9
Force (500 bar)	kN	5.7	10	15.7	24.6
Spring Force	N	25	50	70	120
Min. Pressure	bar	10	10	10	10
Oil Volume / 10 mm Stroke	cc	1.13	2.01	3.14	4.91
A1	mm	39	47.5	57.5	59.5
A2	mm	45.5	53.5	65.5	68.5
B	mm	28	33	42	42

Items	Unit	TC-12	TC-16	TC-20	TC-25
C	mm	8.5	9.5	9.5	11.5
D1 / D2	mm	2.5 / 10	3 / 9	4 / 12	5 / 14
ØE1 / ØE2	mm	12 / 11	16 / 15	20 / 19	25 / 23
F	mm	M22×1.5	M26×1.5	M30×1.5	M38×1.5
G	mm	M6×1.0	M6×1.0	M8×1.25	M8×1.25
H	mm	6	6	8	8
J (Min. / Max.)	mm	16 / 27	20 / 32	24 / 41	28 / 38
K (Max.)	mm	8	9	9	11
L (Min.)	mm	25	30	35	43
M (Min. / Max.)	mm	9 / 12	12 / 16	14 / 20	18 / 25
SW1	mm	17	22	24	32
SW2	mm	10	13	17	19